

County: Desoto
 Permit #: _____
 Driller: Jones W. Mascin
 Date drilling completed: 9-3-08

State Well Report
Part 1 - Driller's Log
 Mississippi Department of Environmental Quality
 Office of Land and Water Resources
 P.O. Box 2309
 Jackson, MS 39225
 (601)961- 5210
 (601)961- 5228 (fax)

For Office Use Only:

Aquifer: _____
 Well #: H-213
 L. S. Elevation: _____
 E-log #: _____

State Law requires that this report be prepared by the license holder responsible for the work and filed with the Department at the above address within 30 days of completion of drilling of the well or borehole.

Information on Well Owner <i>(Landowner if borehole is not for a water well)</i>	Well or Borehole Location
Owner Name: <u>Bob Higginbottom</u>	Latitude: <u>34.54,940</u> Longitude: <u>89.48,200</u>
Mailing Address: <u>3808 Iron Bridge Rd.</u>	Method of Lat/Long (circle one): Conventional Survey, <u>56</u> <u>12</u>
<u>College/Woolsey subdivision</u>	USGS quad: <u>Hand-held GPS</u> , Survey-grade GPS
<u>Olive Branch MS 38654</u>	<u>SW 1/4 NE 1/4 Sec 14 Twn 25 Rng 6W</u>
City State Zip Code	Distance Direction Nearest Town
Telephone No. <u>(901) 216-6414</u>	<u>1 1/2</u> Miles <u>NE</u> of <u>Cedarview</u>

Well / Borehole Data

Date drilling started: 9-3-08 Date drilling completed: 9-3-08 Hole depth: 185 Hole diameter: 6 3/4

Location of the source of any surface water used for drilling: NA

Method of dosing and volume of Chlorine used in drilling and development: NA

Logs run (circle all applicable): No log run Electric Gamma Ray Density Sonic Neutron Other: _____

Name of organization running log(s): NA

Purpose of borehole (check one): Water Well Geotechnical/Geological Investigation _____ Ground Source Heat Pump _____

Seismic Survey _____ Other (describe) _____

If drilling is not related to water well construction, skip the remainder of this block

Purpose of Well (check one): Home Industrial _____ Public Supply _____ Irrigation _____ Fish Culture _____ Other: _____

If a flowing well, method of flow regulation: Valve NA Other (describe) _____

Static Water Level: 100 feet above or below (circle one) land surface Date measured: 9-15-08

Method of Measurement (circle one) steel tape electric tape air line other: String Weight

Well depth: 185 Well grouted to a depth of 50 feet Type of grout (circle one): Neat Cement Bentonite Mix

Casing length: 165 feet Casing diameter: 4 inches Type of casing: pvc

Screen length: 20 feet Screen diameter: 4 inches Type of screen: pvc

Screen slot size: 010 inches Setting depth: From 165 feet to 185 feet

Type of completion (circle all applicable): Gravel packed Underreamed Telescoped Open hole Natural Development

Other (describe): NA

Top of lap pipe or reduction in casing: NA feet. ***If telescoped or more than one screen, describe on next page***

Form: OLWR-SWR-1A (04/08)

RECEIVED
 OCT 02 2008
 BY: OLWR

H-213

The sketch below only required for water wells

If well telescopes, show depths on sketch.

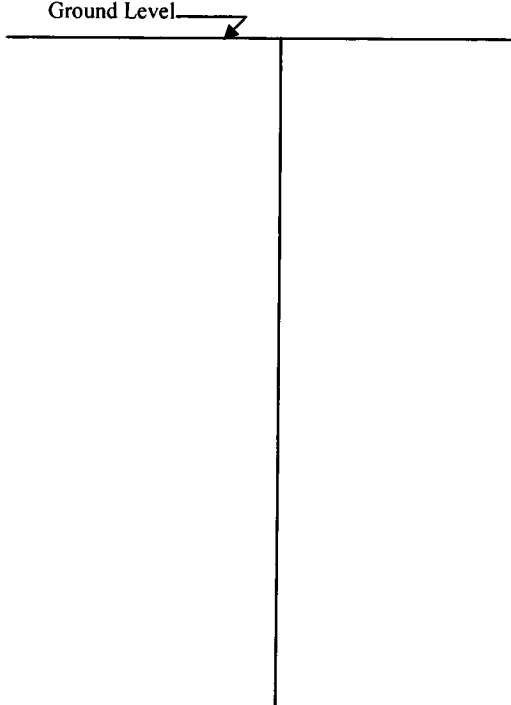

Description of formations encountered must be provided for all wells and boreholes, unless specifically exempted by regulations

Description of Formations Encountered	From (depth)	To (depth)
clay dirt.	Ground Level	30
red sand	30	35
gravel	35	50
Blue clay	50	100
white sand	100	130
white clay	130	135
white sand.	135	185

If more than one screen, show location of each on sketch

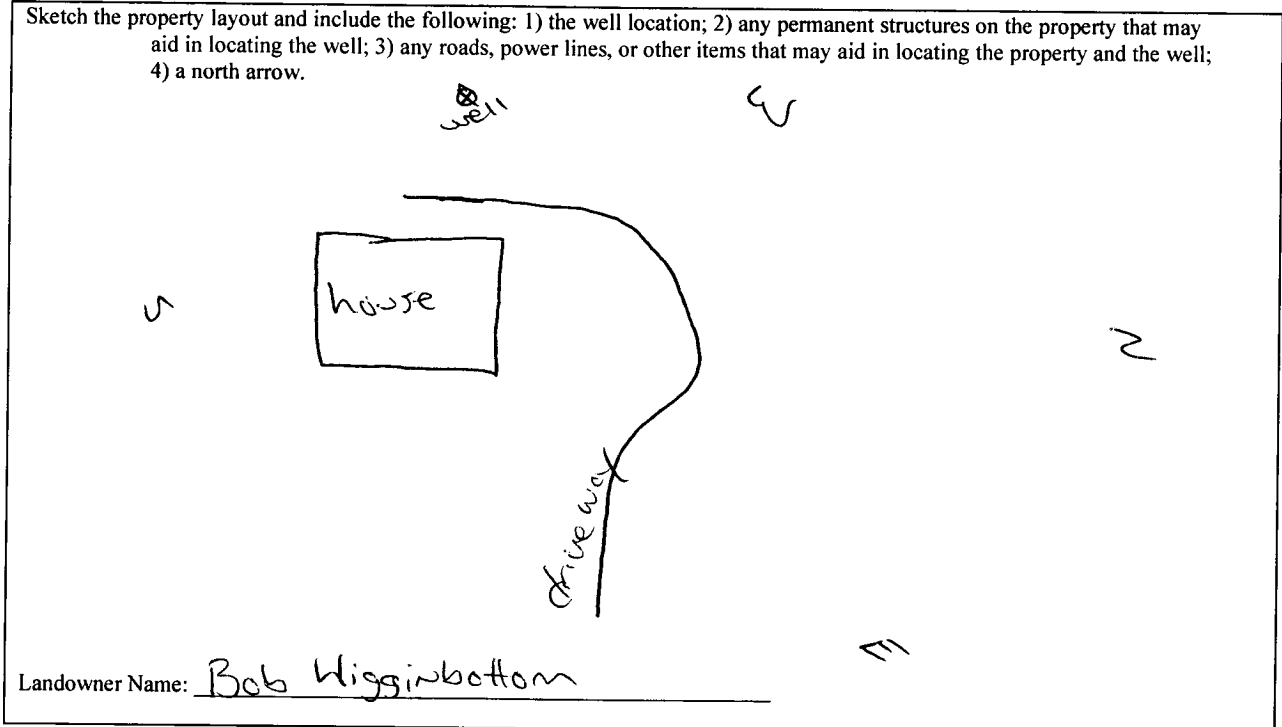

Form: OLWR-SWR-1A (04/08)

I certify that the well/borehole was drilled, constructed, and completed in accordance with all applicable requirements of the Mississippi Department of Environmental Quality and the Mississippi Department of Health regulations, if applicable, and state laws.

Jones W. Mason 0-620 9-30-08

Print Name of Responsible Licensee and License No. Date

Jones W. Mason

Signature of Licensee

RECEIVED
OCT 02 2008
BY: OLWR

STATE WELL REPORT

Part 2

Pump Installer's Completion Report
 Mississippi Department of Environmental Quality
 Office of Land and Water Resources
 P.O. Box 2309
 Jackson, MS 39225
 (601)961-5210
 (601)961-5228 (fax)

County: Desoto
 Permit #: _____
 Driller: Jones W. Mason
 Date completed: 9-15-08
Copy information from block on Part 1

For Office Use Only:

Aquifer: _____
 Well #: H-213
 Elevation: _____

This part of the report must be completed by a licensed water well contractor or a licensed pump installer. A copy of Part 1 of the report must be attached and both parts filed with the Department at the above address within 30 days of well completion.

Well Owner Information	Well Location
Owner Name: <u>Bob Higginbottom</u>	Latitude: <u>34.54.940</u> Longitude: <u>89.48.200</u>
Mailing Address: <u>3808 Iron Bridge Rd.</u>	Method of Lat/Long (check one): Conventional Survey _____
<u>college / woolsey subdivision</u>	USGS quad _____, Hand-held GPS <input checked="" type="checkbox"/> Survey-grade GPS _____
<u>Olive Branch ms 38654</u>	<u>SW 1/4 NE 1/4 Sec 14 T 2S R 6W</u>
City State Zip Code	Distance Direction Nearest Town
Telephone No. <u>(901) 216-6414</u>	<u>1 1/2</u> Miles <u>NE</u> of <u>cedarview</u>

Pump Type Circle one	Power Type Circle one
Air Lift Jet <input type="checkbox"/> <u>Submersible</u>	Diesel Engine Gasoline Engine Natural Gas
Bucket Piston <input type="checkbox"/> Turbine <input type="checkbox"/>	<u>Electric Motor</u> Hand Tractor PTO
Centrifugal Rotary <input type="checkbox"/> Flowing Well <input type="checkbox"/>	Windmill Other (specify): _____
Other (specify): _____	Horse Power Rating of Motor: <u>3 hp-</u>
Date Pump Installed: <u>9-15-08</u>	Setting Depth: <u>140</u> feet
Rated Pump Capacity: <u>30</u> Gallons Per Minute	Number of Stages: <u>14</u>

Pump Test Data	Method of Measuring Water Level Circle one
Date Well Tested: <u>9-15-08</u>	Air Line Electric Measuring Line Steel Tape
Static Water Level (A): <u>100</u> Feet Below Land Surface	Other (specify): <u>string weight</u>
Pumping Water Level (B): <u>NA</u> Feet Below Land Surface	For flowing well, measured shut in head: <u>NA</u> feet
Drawdown [(B) - (A)]: <u>NA</u> Feet Below Land Surface	Well yielded <u>30</u> GPM with a drawdown of
Test Pumping Rate: <u>30</u> Gallons Per Minute	<u>NA</u> feet after <u>24</u> hours of pumping
Duration of Pump Test (minimum 4 hours): <u>24</u> hours	

I HEREBY CERTIFY that the above statements are true to the best of my knowledge.

Jones W. Mason 0-620 Jones W. Mason
 Print Name of Pump Installer and License No. (if applicable) Signature of Pump Installer

Form: OLWR-SWR-118 (1/4/08) **RECEIVED**

OCT 02 2008
 BY: OLWR